

Research & Technology Center



The Research & Technology Center is a city-owned 26,000+ square foot business incubation facility. The facility houses research and technology based businesses. The incubator is designed to assist business and industry in start-up and initial growth stages.

Available Space:

- 2,843 sq. ft. – includes reception area, conference room, two offices, dirty room, clean room, and laboratory space. Dirty room and clean room can be office space. **Available immediately.**
- 4,630 sq. ft. – includes reception area, conference room, seven offices, laboratory, cold storage, shop area w/ overhead doors. **Available February 1, 2010.**

Common Space:

- Break room, large conference room, restroom facilities, signage, and paved parking lot.

Location:

- Located on 32nd Avenue, approximately ¼ mile east of the intersection of Interstate 29 and US Highway 14. South Dakota State University is within one mile. Adjacent facilities include: Capital Card Systems, Swiftel Center (events facility), and Larson Ice Center.

Lease Rates:

- Rates: The Research & Technology Center is a business incubation facility offering lease rates on a graduated scale. Rates begin at 75% of market rate gradually reaching market rate after six years. City is responsible for the exterior and interior structural maintenance of the facility and maintaining the common areas and heating and cooling system.

Contact Info:

Mike Struck, Community Development Director
City of Brookings
311 3rd Avenue
Brookings, SD 57006
Phone: (605) 692-6629
Email: mstruck@cityofbrookings.org



Main Entrance



Freestanding Signage



Aerial

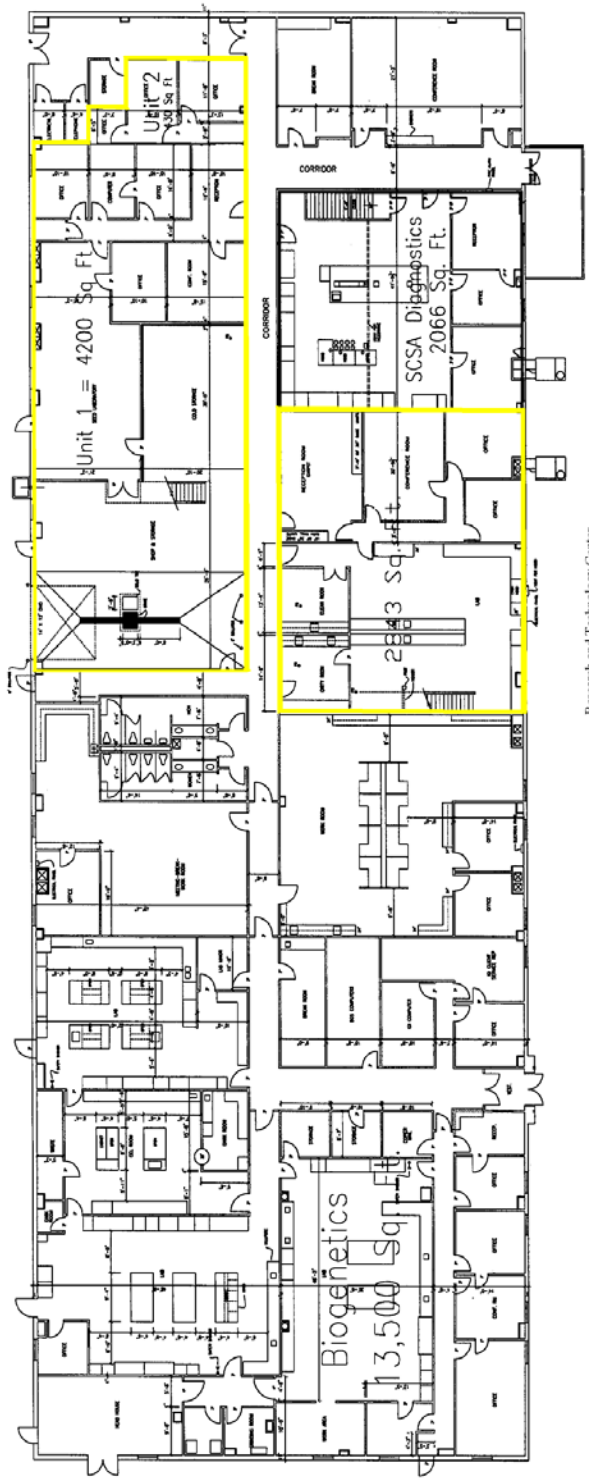

Research and Technology Center

